



Whilst every effort is made to give a fair description, the accuracy of these particulars is not guaranteed, neither do they constitute an offer or contract.

MATHESONS ESTATE AGENTS have not tested any apparatus, equipment, fitting or services and so cannot verify that they are in working order. The buyer is advised to obtain verification from their solicitor or surveyor. Measurements are correct to within +/- 6 A sonic tape is used. None of the statements contained in these particulars or any of our properties are to be relied upon as a representation of fact.

166 Manor Park Road
Harlesden
London
NW10 4JT
T: 020 8965 2250
E: sales@mathesonsestates.com
www.mathesonsestates.com



Longstone Avenue, London, NW10 3TS

Asking Price £385,000 Leasehold



KEY FEATURES:

- TWO BEDROOM
- PURPOSE BUILT
- SECOND FLOOR FLAT
- CLOSE TO ROUNDWOOD PARK
- DOUBLE GLAZING
- GAS CENTRAL HEATING
- POPULAR ROAD
- COMMUNAL GARDENS
- RESIDENTS ONLY PARKING
- LONG LEASE

CHURCHILLMATHESONS are pleased to offer FOR SALE this TWO BEDROOM PURPOSE-BUILT SECOND FLOOR FLAT situated in a POPULAR ROAD CLOSE TO ROUNDWOOD PARK.

This SPACIOUS flat has a good size living room, TWO DOUBLE BEDROOMS, FITTED KITCHEN, MODERN BATHROOM and Communal Gardens.

Further benefits are the property has been REFURBISHED throughout including NEW BOILER, gas central heating, double glazing and being sold with 125 years lease.

Longstone Avenue is located close to local amenities of Harlesden Town Centre and local transport links including a 20 minute walk to Harlesden Station (Bakerloo Line & London Overground Line - Zone 3) & Willesden Junction Station (Bakerloo Line & London Overground Line - Zone 2 & 3) The total floor area is approximately 690 SQ/FT (64 SQ/M)

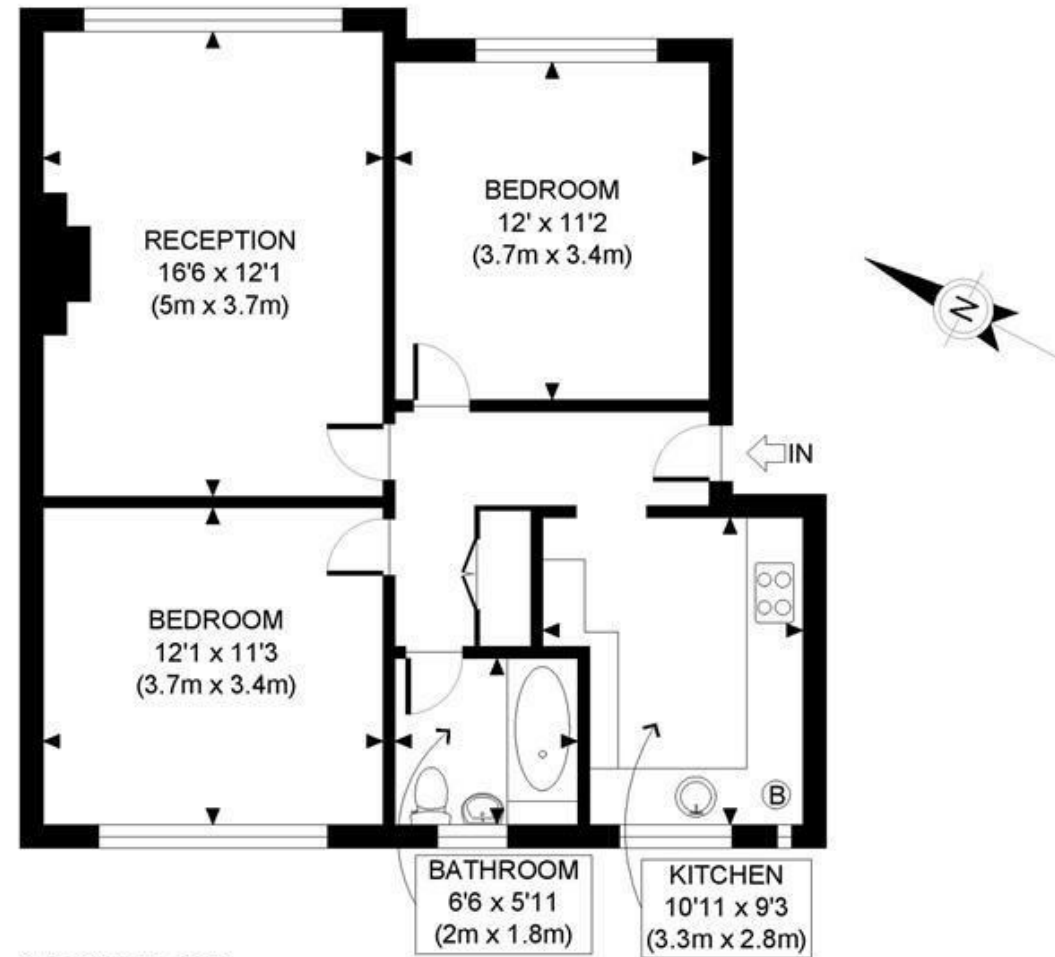

SECOND FLOOR
GROSS INTERNAL
FLOOR AREA 690 SQ FT



APPROX. GROSS INTERNAL FLOOR AREA: 690 SQ FT/ 64 SQM

PROPERTY PHOTO PLANS.co.uk
ONE STOP SHOP FOR PROPERTY MARKETING

Whilst every attempt has been made to ensure the accuracy of the floor plan contained here, measurements of the doors, windows, rooms and any other items are approximate and no responsibility is taken for any errors, omissions, or miss-statement. This plan is for illustrative purposes only and should be used as such by any prospective client. The services, systems and appliances shown have not been tested and no guarantee as to the operability or efficiency can be given.

